

★  
**OPEN RANGE**  
 Journeyer

2010 Fifth Wheel  
 JF335BHS  
 Effective Date: 4/21/09

# MSRP PRICE SHEET

**DEALER NAME:** Berryland Campers  
**VIN #:** 5XMFJ3327A5001547

**DÉCOR OPTIONS:**

- Haversham (Blue/Brown)
- Lifelong (Green)
- Sheridan (Neutral/Tan)

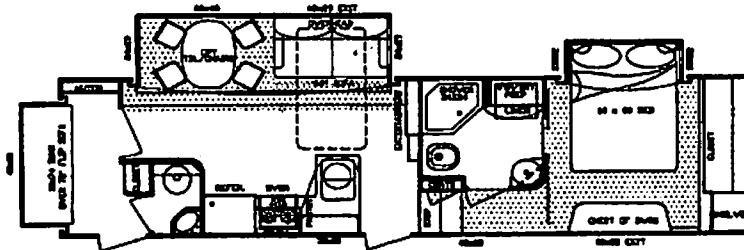

**JF335BHS**

**335BHS**  
MSRP EX. TAX & LICENSE

**OPTIONAL FEATURES**

	Price	Description
X	\$651	2nd A/C 13,500 BTU, Non-Ducted
	\$350	Dinette Booth IPO Free Standing Table & Chairs
	\$1,113	Dual Pane Windows
X	\$735	16" Aluminum Wheels & Tires
	\$308	Power Rear Stabilizer Jacks
	\$210	King Pin Stabilizer Jack
	\$350	Fantastic Fan in: Bedroom / Bathroom / Kitchen
	\$693	19" Flat Screen Bedroom TV
	\$833	Slide-Out Awning Covers (2)

	Price	Description
X	\$700	Four Seasons Protection Package (Mandatory)
X	\$2,100	Entertainment Package (Mandatory)
X	\$3,500	Executive Living Package (Mandatory)
X	\$91	RVIA
	\$273	Q.A.I. Construction (Canadian Dealers ONLY)
	\$91	Go RVing MEP Fee (Canada)
		State Seal

**Four Seasons Protection Package:** Atwood High Performance Furnace, Double Insulated Baggage Doors, Heated Storage Area, Heated Underbelly, Insulated Slide-Floor, Heated & Enclosed Dump Valves, Vented Attic, Remote Digital Thermostat, R-9 Walls, R-21 Floor, up to R-28 Ceiling.

**Entertainment Package:** 26" LCD TV, DVD/CD/MP3/AM/FM Player w/ Surround Sound Speakers, Dual Speaker in Pass-Through Storage Area, TV Antenna and booster.

**BASE PRICE:** \$38,150.00

**OPTIONS:** \$7,777.00

**DISCOUNT:** \_\_\_\_\_

**DESTINATION CHG:** \$992.00

**FUEL SURCHARGE:** \$243.00

\*\*Fuel surcharge to fluctuate with current fuel prices and may reflect an increase or decrease accordingly.

**TOTAL:** \$47,162.00

**Executive Living Package:** *INTERIOR OPTIONS* - Large 8 Cubic Ft. Refer, 10 Gal. Quick Recovery Water Heater, 15,000 BTU A/C, Power Vent, Residential Hide-a-bed Sofa, Residential Mattress, Spice Rack, Pull-Out Pantry. *EXTERIOR OPTIONS* - Power Awning, "MaxxAir" Vent Cover, 15" Steel 6-Lug Wheels.

**Standard Features:** *INTERIOR* - High Output Range w/ Ignitor and Large 22" Oven. HUD Approved Luan Wall Board, Maple Hardwood Raised Panel Glazed Cabinet Doors, Full Extension Drawer Guides, Fluorescent Light in Galley, Pull-Out Waste Basket, Glass Shower Door & Surround, Sky Light above Shower, Cable Hook-up, Satellite Prep, Large Lavatory Bowl Sink, Porcelain Toilet, Motion Detector Night Light. *EXTERIOR* - Exterior Utility Center w/ Black Tank Flush, "Dexter" Wide Stance E-Z Lube Axles, Equa Flex Suspension, Radial Tires, Front & Rear Stabilizer Jacks, Large Triple 9" Entry Steps, Dual Outdoor Security Lights, Extended Gutter Spouts, Large Stainless Steel Assist Grab Handle.  
**NEW STANDARD FEATURES:** *Wire and Frame for 2nd A/C (includes 50 amp service), Rear Ladder, Dual LP with Slide Trays (80lb capacity).*

\*\*\* Prices, features and options are subject to change without notice.

OPEN RANGE RV COMPANY - 3195 N. S.R. 5, SHIPSHEWANA, INDIANA 46565 PHONE: (260) 768-7771 FAX: (260) 768-7077

4/21/2009

**SALES FAX: (260) 768-7077**