

★ OPEN RANGE MSRP PRICE SHEET

2010 Fifth Wheel
399BHS
Effective Date: 11/01/2008

DEALER NAME: Berryland Campers
VIN #: 5XMF3923A5001489

DÉCOR OPTIONS:

- Haversham (Blue/Brown)
- Lifelong (Green)
- Sheridan (Neutral/Tan)

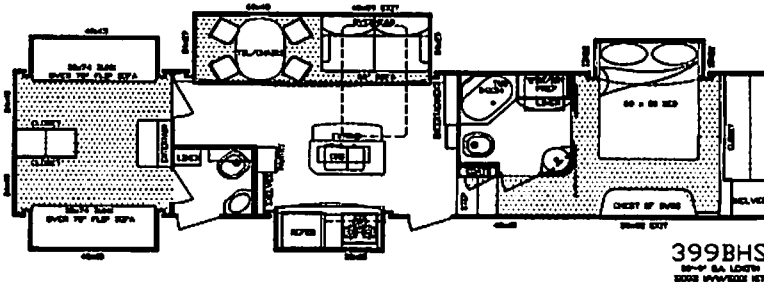

399BHS

OPTIONAL FEATURES

	Price	Description
X	\$770	2nd A/C 15,000 BTU, Ducted
	\$350	Dinette Booth IPO Free Standing Table & Chairs
	\$1,113	Dual Pane Windows
	\$693	Generator Prep
X	\$308	Power Rear Stabilizer Jacks
X	\$693	Fireplace
X	\$413	Central Vacuum
	\$350	Additional Fantastic Fan in Bedroom
	\$1,813	Slide-Out Awning Covers (5)

	Price	Description
X	\$700	Four Seasons Protection Package (Mandatory)
X	\$2,800	Entertainment Package (Mandatory)
X	\$4,200	Executive Living Package (Mandatory)
X	\$91	RVIA
	\$273	Q.A.I. Construction (Canadian Dealers ONLY)
	\$91	Go RVing MEP Fee (Canada)
		State Seal

Four Seasons Protection Package: Atwood High Performance Furnace, Double Insulated Baggage Doors, Heated Storage Area, Heated Underbelly, Insulated Slide-Floor, Heated & Enclosed Dump Valves, Vented Attic, Remote Digital Thermostat, R-9 Walls, R-21 Floor, up to R-28 Ceiling.

Entertainment Package: 42" LCD TV, 19" LCD TV w/Portable Swing Arm, DVD/CD/MP3/AM/FM Player w/ Surround Sound Speakers, Dual Speaker in Pass-Through Storage Area, TV Antenna and booster.

**Fuel surcharge to fluctuate with current fuel prices and may reflect an increase or decrease accordingly

BASE PRICE:	\$50,624.00
OPTIONS:	\$9,975.00
DISCOUNT:	_____
DESTINATION CHG:	\$992.00
FUEL SURCHARGE:	\$175.00
TOTAL:	\$61,766.00

Executive Living Package: INTERIOR OPTIONS - Large 8 Cubic Ft. Refer, 10 Gal. Quick Recovery Water Heater, 15,000 BTU A/C, Corian Counter Tops in Galley, "Fantastic Fan", Residential Hide-a-bed Sofa, "Posterest" Pillowtop Residential Mattress, Spice Rack, Pull-Out Pantry. EXTERIOR OPTIONS - Power Awning, "MaxxAir" Vent Cover, King-Pin Stabilizer. **NEW STANDARD FEATURE:** Dinette Step-Chair.

Standard Features: INTERIOR -High Output Range w/ignitor and Large 22" Oven. HUD Approved Luan Wall Board, Maple Hardwood Raised Panel Glazed Cabinet Doors, Full Extension Drawer Guides, Fluorescent Light in Galley, Pull-Out Waste Basket, Washer/Dryer Prep, Glass Shower Door & Surround, Sky Light above Shower, Cable Hook-up, Satellite Prep, Glass Vessel Lavatory Bowl Sink with Single Lever Lavatory Faucet, Porcelain Toilet, Motion Detector Night Light. EXTERIOR - Coutoured Front Cap for Superior Turning Radius, Exterior Utility Center w/Black Tank Flush, Battery Disconnect, "Dexter" Wide Stance E-Z Lube Axles, Equa Flex Suspension, Radial Tires, Wide Stance Front Electric Jacks, Rear Stabilizer Jacks, Large Triple 9" Entry Steps, Dual Outdoor Security Lights, Extended Gutter Spouts, Large Stainless Steel Assist Grab Handle.
NEW STANDARD FEATURES: Wire and Frame for 2nd A/C (includes 50 Amp Service), 16" Aluminum Wheels & Tires, Rear Ladder, Dual LP with Slide Trays (80lb capacity), Rear Fiberglass Cap.

*** Prices, features and options are subject to change without notice